



## *Installation Instructions for the TRIMLINE (TL1) AED Cabinet*

**IMPORTANT: Your TL1 has been supplied with an adhesive label “FOR USE BY TRAINED RESPONDERS ONLY”. As the installer, you are responsible for applying this label based on your state’s guidelines for who is eligible to use the AED device stored in your TL1 cabinet.**

### **Cabinet Mounting:**

- 1) Locate studs or identify structural material capable of providing sufficient support.
- 2) Select fasteners (not included):
  - a) Steel studs—#10 x 2-1/2” fine thread
  - b) Wood studs—#10 x 2-1/2” coarse thread
  - c) Block or concrete—plastic wall anchors of minimum 1-1/2” depth
  - d) Hollow wall—minimum grip of 5/8 inch
- 3) The figure below shows the 4 mounting holes and their corresponding spacing in inches. It is recommended that fasteners are used in all 4 holes. Position the cabinet with a minimum of 2 fasteners attached to studs or concrete. See Mounting Height Guidelines below.

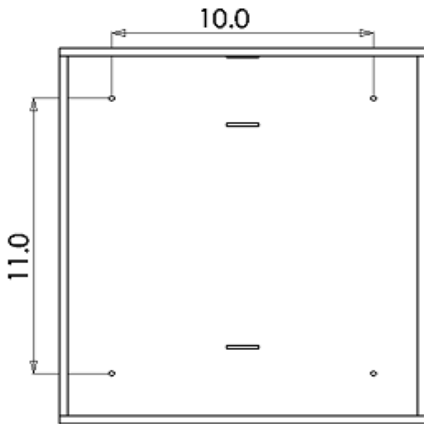

### **Mounting Height Guidelines:**

ADA (Americans with Disabilities Act) guidelines specify that in an unobstructed approach, the reach to the door handle shall not exceed 48 inches from the floor. The maximum side reach is to be less than 54 inches.

### **Alarm Operation**

- 1) The alarm can be activated or deactivated externally by removing the cap plug on the upper left side of the cabinet, inserting a small diameter screwdriver, paperclip, or similar device in the hole and moving the switch up (ON) or down (OFF). (See figure on right)
- 2) The alarm can also be accessed from inside the cabinet.
- 3) The alarm is supplied with three 1.5 volt LR44 / AG13 batteries. To replace the batteries, remove the alarm that is attached by hook and loop. Access the batteries through the front of the alarm by sliding the lower panel down. Replace batteries and re-install alarm tightly in the upper left corner of the cabinet.
- 4) Opening the door will trigger the alarm. Closing the door will stop the alarm.

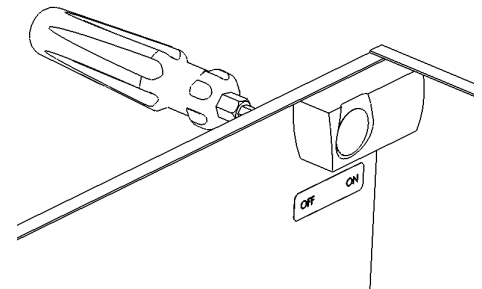

**Maintenance:** Replace the batteries annually or as needed.

**Warranty:** One year limited warranty.

**HeartStation**  
**1000 Brown Street, Wauconda, IL 60084**  
**(800) 818-2939**